

SCHEDULE "A"

ALL that certain lot, piece or parcel of land situate lying and being at Shubenacadie, in the County of Hants and Province of Nova Scotia, shown as Lot #2 on a plan entitled Subdivision of Lands of Heirs of James Phillips, prepared by R. A. Fulton, N.S.L.S., dated the 31st day of January, 1977, the said lands being more particularly described as follows:

BEGINNING at an iron post situated thirty-three feet (33') south of the centre line of the No. 2 Highway leading from Shubenacadie to Milford Station and being the northeast corner of Lot #1;

THENCE northerly fifty-two degrees fifty-seven minutes east (N 52° 57' E) along the southern boundary line of the said highway for a distance of fifty-seven point eight feet (57.8') to an iron post on the said southerly boundary line;

THENCE continuing north fifty-four degrees zero one minutes east (N 54° 01' E) along the southern boundary line of the said highway for a distance of four hundred and forty point eight six feet (440.86') to a point on the said highway;

THENCE continuing northerly forty-nine degrees forty-four minutes east (N 49° 44' E) along the southerly boundary line of the said highway seventy-six point six eight feet (76.68') to an iron post situated at the intersection of the southeasterly boundary of the said No. 2 Highway with the northwesterly boundary of the Right-of-Way of the Canadian National Railways;

THENCE south forty degrees zero four minutes west (S 40° 04' W) along the northwesterly boundary line of the said Canadian National Railways Right-of-Way for a distance of five hundred and ninety-seven point zero eight feet (597.08') to an iron post and being the southeast corner of Lot #1;

THENCE north thirty-four degrees ten minutes west (N 34° 10' W) along the eastern sideline of the said Lot #1 for a distance of one hundred and thirty-seven point two feet (137.2') to the place of beginning.

The said lot containing thirty-eight thousand two hundred and seventy-two square feet (38,272 sq. ft.).

All bearings magnetic A.D. 1977.



Property Online Map

Date: February 27, 2026 16:43:59

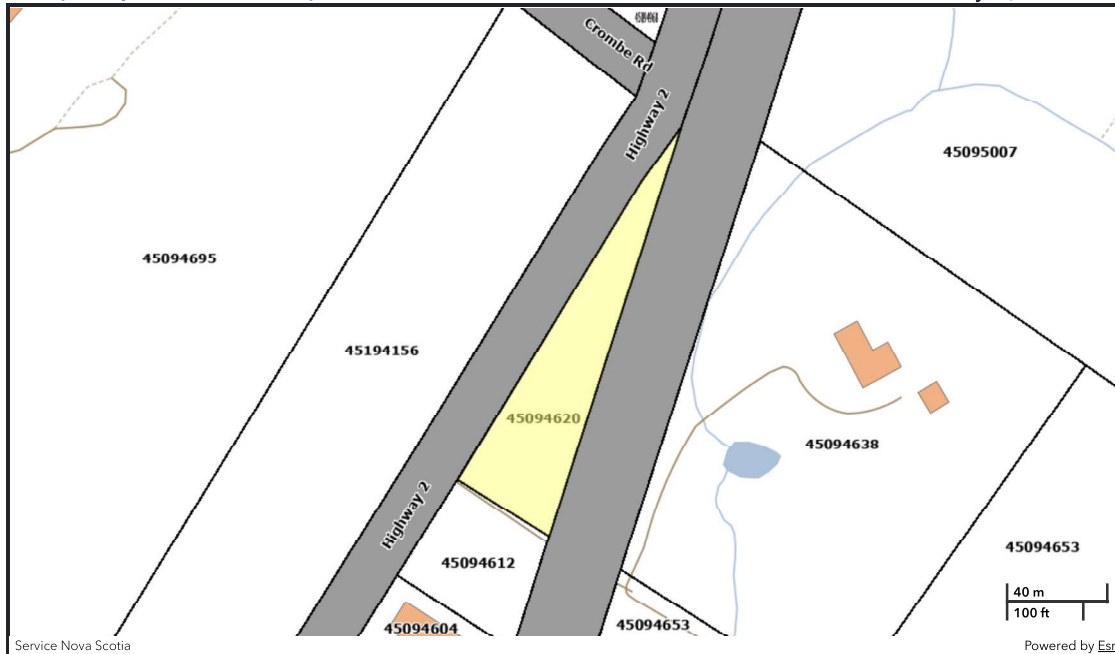

PID:	45094620	Address:	2545 NO 2 HIGHWAY SHUBENACADIE LOT 2	AAN:	00674621
County:	HANTS COUNTY	Owner:	DOROTHY J CARROLL	Value:	\$45,000.00 (2026 RESIDENTIAL TAXABLE)
LR:	NOT LAND REGISTRATION				

The Provincial mapping is a graphical representation of property boundaries which approximate the size, configuration and location of parcels. Care has been taken to ensure the best possible quality, however, this map is not a land survey and is not intended to be used for legal descriptions or to calculate exact dimensions or area. The Provincial mapping is not conclusive as to the location, boundaries or extent of a parcel [Land Registration Act subsection 21(2)]. THIS IS NOT AN OFFICIAL RECORD.

Property Online Version 1.0

This page and all contents are copyright © 1999-2026, [Government of Nova Scotia](#), all rights reserved.
If you have comments regarding our site please direct them to: propertyonline@novascotia.ca
Please feel free to [Submit Problems](#) you find with the Property Online web site.