

DATED: FEBRUARY 27, 2024 PLAN DRAFTED BY WAYNE H. STILLMAN.

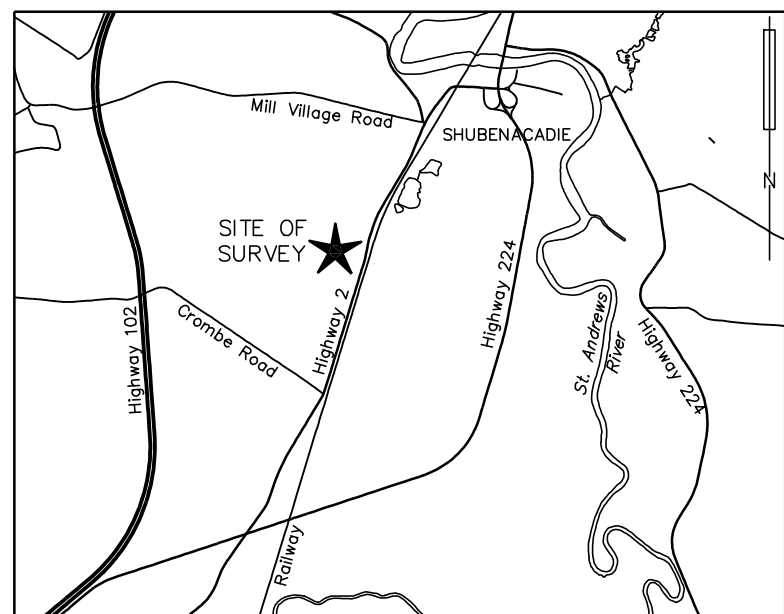

Key Plan 1:50,000

LEGEND

— BOUNDARIES PREVIOUSLY SURVEYED
 - - - PROPOSED LOT BOUNDARIES
 - - - PROPOSED LOT DIVIDERS
 — OTHER BOUNDARY
 ± PLUS OR MINUS
 PID PARCEL IDENTIFIER NUMBER

ALL DISTANCES ARE GRID AND SHOWN IN METRES UNLESS OTHERWISE NOTED.
 NATURAL FEATURES DERIVED FROM EXISTING SURVEYS AND THE NOVA SCOTIA TOPOGRAPHIC DATABASE.
 PLAN DRAFTED BY WAYNE H. STILLMAN.

- NOTES**
- (1) LOTS 1 TO 47 INCLUSIVE TO HAVE A MINIMUM ROAD FRONTAGE OF 18 METRES.
 - (2) LOTS 1 TO 47 INCLUSIVE TO HAVE AN AREA MINIMUM OF 550 SQUARE METRES.
 - (3) LOTS SUBJECT TO CHANGE BASED ON DESIGN SPECIFICATIONS, UNFORESEEN SITE CONDITIONS AND ARE SUBJECT TO A COMPLETE FIELD SURVEY.
 - (4) LOTS 1 TO 47 INCLUSIVE TO BE SERVICED BY MUNICIPAL WATER AND SEWER.

STILLMAN ONSITE INC.

65 GLENGARRY ROAD—ENFIELD—NOVA SCOTIA—B2T 1H2
 PHONE: (902) 223-5582
 wayne@stillmanonsite.ca



PLAN SHOWING
LOTS 1 TO 47
 INCLUSIVE
 SUBDIVISION OF LOT G, PID 45097227
 PROPOSED REZONING FROM RU TO R2

HAVENWOOD DRIVE
 COUNTY OF HANTS
 PROVINCE OF NOVA SCOTIA

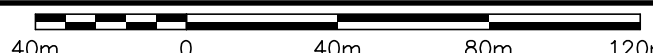
Plan Number DD-MM-2024	Job Number S10-2024	Scale 1:2000	
---------------------------	------------------------	-----------------	---